

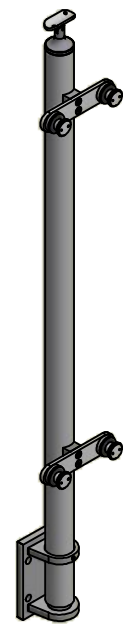

PARTS LIST

ITEM	QTY	PART NUMBER	DESCRIPTION
1	1	LG31942FFMA	Post, Stainless Steel, 1-1/2 Inch Pipe (1.90 OD) Sch 40, 42 High, Brushed Satin Finish, Grade 316, Fascia Mount, Post Assembly
2	1	WR31900FA	ASSY, FASCIA MOUNT POST BRACKET
3	1	BAH3N3816-0200	SCREW, SS, 3/8-16 X 2.00 Inch, Button, Allen Head
4	2	LXFP30-2	Point Fitting, Stainless Steel, 30 mm Head, 2 Point, Flat Plate, Brushed Satin Finish, Grade 316, 0.50 Inch Glass
5	2	LXFP30-1.90	Point Fitting, Stainless Steel, 1.90" OD Adapter, Brushed Satin Finish, Grade 316, 0.50 Inch Glass
6	4	FAH3NM06C-0030	Screw, Stainless Steel, M6-1.0 x 30mm, Socket Flat Head Machine Screw, A4-70
7	1	SS507	SADDLE, SWIVEL, CAST W/ HOLES

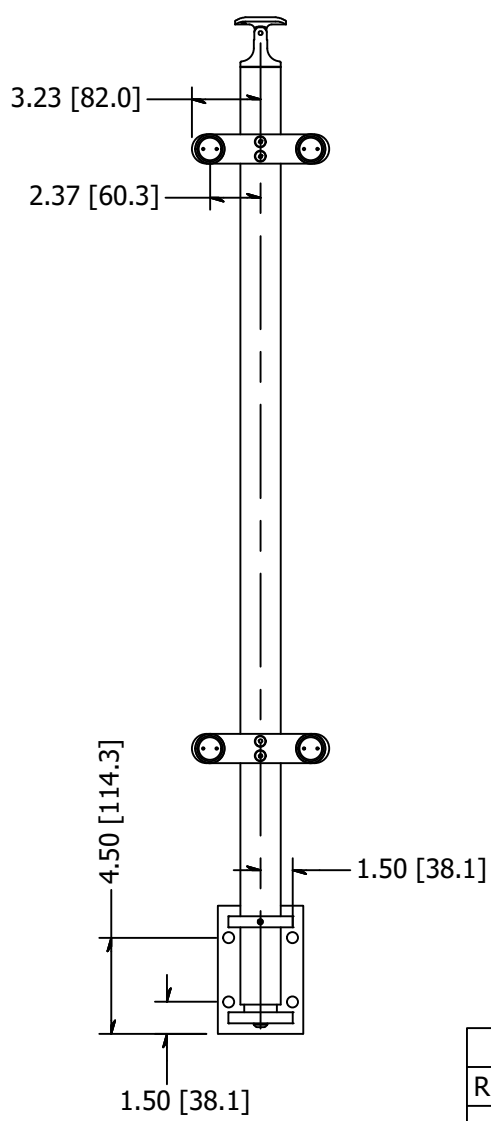
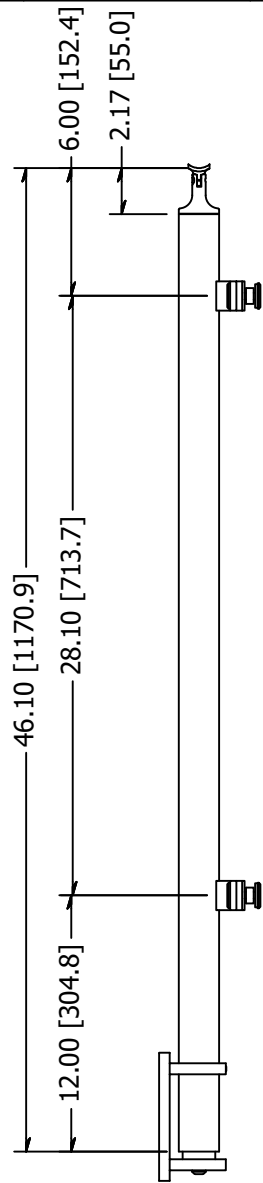

REVISION HISTORY		
REV	DESCRIPTION	DATE
2	Drawing Update	6/25/2019

<b>TOLERANCE</b>  UNLESS OTHERWISE NOTED, TOLERANCES TO CONFORM TO ES.03.011	MATERIAL:	316 Stainless		DESCRIPTION: Intermediate Post, Stainless Steel, 1-1/2 Inch Pipe (1.90 OD) Sch 40, 42 High, Brushed Satin Finish, Grade 316, Fascia Mnt, Flat
	FINISH:	Satin Brushed		
	WEIGHT:	N/A		DATE: 6/25/2019 DRAWN BY: T. Kolbach ITEM NUMBER: LG31942DMFM.4
			REV: 2	10600 W Brown Deer Rd Milwaukee, WI 53224 COLLABORATIVE METALWORKS <a href="http://www.wagnercompanies.com/">http://www.wagnercompanies.com/</a>

