



PARTS LIST

ITEM	QTY	PART NUMBER	DESCRIPTION
1	1	LG31942MSMA	Intermediate Post, Stainless Steel, 1-1/2 Inch Pipe (1.90 OD) Sch 40, 42 High, Brushed Satin Finish, Grade 316, Surface Mnt, Assm
2	1	2077.316.4	FLANGE SS SNAPON COVER 1.90 316 #4
3	1	SS507	SADDLE, SWIVEL, CAST W/ HOLES
4	4	LXTB51-1	Point Fitting, Stainless Steel, 51 mm Head, 1 Point, Tubular Body, Brushed Satin Finish, Grade 316, 0.50 Inch Glass

B

B

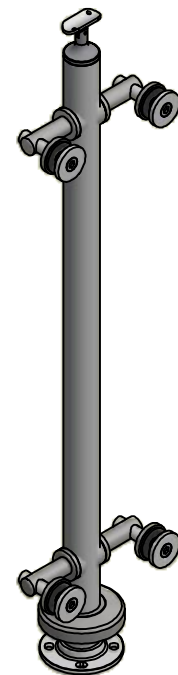
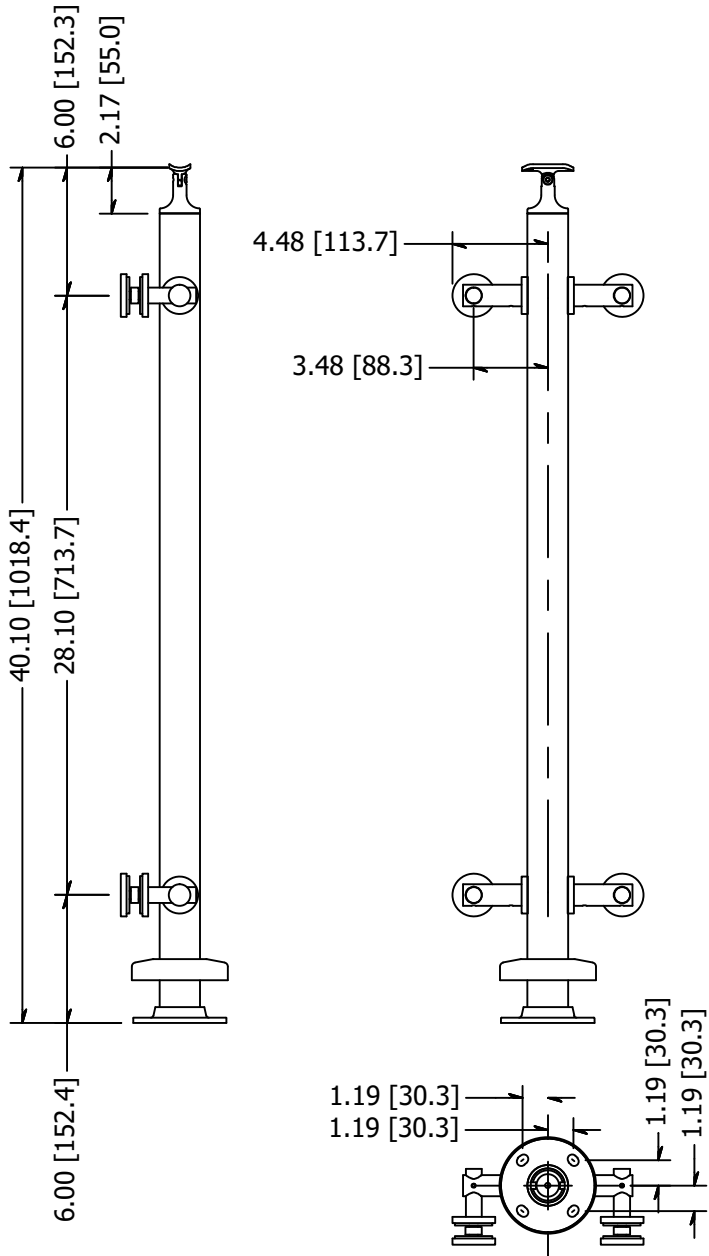

A

A

REVISION HISTORY

REV	DESCRIPTION	DATE	APPROVED
1	Revise to metric	3/24/2015	TLK
2	Revise LXTB51-1 to LX51FBS	10/27/2015	KGB
3	Revise LX51FBS to LXTB51-1	8/23/2016	TLK
4	Drawing Update	6/25/2019	GPW

<p><b>TOLERANCE</b></p> <p>UNLESS OTHERWISE NOTED, TOLERANCES TO CONFORM TO ES.03.011</p>	<p>MATERIAL:</p> <p>316 Stainless</p>	<p>DESCRIPTION:</p> <p>Intermediate Post, Stainless Steel, 1-1/2 Inch Pipe (1.90 OD) Sch 40, 42 High, Brushed Satin Finish, Grade 316, Surface Mnt, 2pt</p>	
	<p>FINISH:</p> <p>Satin Brushed</p>	<p>DATE:</p> <p>6/25/2019</p>	<p>REV:</p> <p>4</p>
	<p>WEIGHT:</p> <p>N/A</p>	<p>DRAWN BY:</p> <p>T. Kolbach</p>	<p>10600 W Brown Deer Rd Milwaukee, WI 53224 <a href="http://www.wagnercompanies.com/">http://www.wagnercompanies.com/</a></p>
	<p>ITEM NUMBER:</p> <p>LG31942CMSM.4</p>		

