

REV
SH
DWG NO 5669B

| REVISIONS | | | |
|-----------|-------------|------|----------|
| REV | DESCRIPTION | DATE | APPROVED |

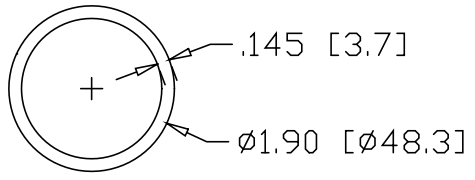
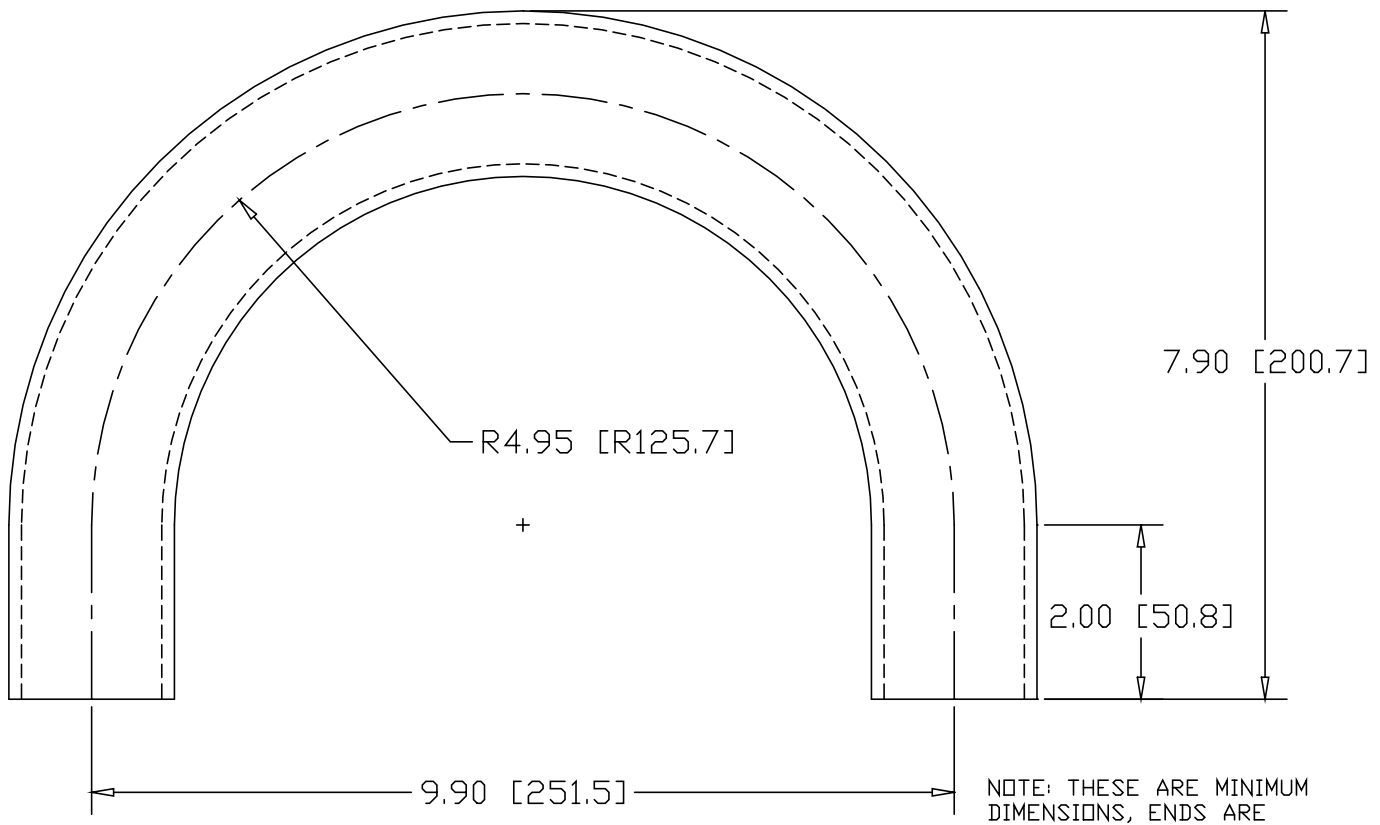

NOTE: THESE ARE MINIMUM DIMENSIONS, ENDS ARE LEFT UNTRIMMED.

INCHES [MILLIMETERS]

| ALTERNATE MATERIAL | PART NUMBER |
|--|-------------|
| 1-1/2" SCH 40 (6063) ALUMINUM PIPE | 5679B |
| 1-1/2" SCH 40 (304) STAINLESS STEEL PIPE | 5689B |

| | | | |
|--|-----------------|--------------------|-----|
| PART NAME 1-1/2" PIPE SIZE 180° ELL X 4" I.R. W/ (2) 2" TANGENTS | | | |
| MATERIAL 1-1/2" SCH 40 A53 STEEL PIPE | | | |
| DATE 4/5/96 | WAGNER | R & B WAGNER, INC. | |
| DRAWN BY RJF | | | |
| FINISH MILL | | | |
| SIZE A | WEIGHT 4.87 LBS | PART NUMBER 5669B | REV |