

## TEST SAMPLE DESCRIPTION

Wagner Part Number: GRSE96XS

### 1.1 General

Product Code/Name	SE96X-12
Test Requirements	STRUCTURAL PERFORMANCE (A) E2353-16 E2358-17
Date of Test	19/09/2019

### 1.2 Barrier/Glass

Glass Make Up	12mm Toughened Glass
Glass Panel Size	Height - 1100mm Width - 1200mm
Overall Size	Height - 1142mm Width - 1200mm
Handrail Used	No Handrail

### 1.3 Spigot System: SE96X

Material	Stainless Steel 2205 Duplex
Overall Size	155mmH x 96mmL x 42mmW
Drawing Supplied	Yes
Fixing Method	M10 316 stainless steel bolt

# PRODUCT TEST REPORT

Wagner Part Number: GRSE96XS

PTY LTD

DATE: 18/09/2019		PRODUCT NUMBER: SE96X		HAND RAIL TYPE: N/A	
GLASS TYPE	12mm Toughened Glass				
GLASS SIZE	1100mmHx1200mmW				
TEST METHOD	Concentrated, Uniform, Infill, loading applied with hydraulic ram				
FIXING TYPE, CENTRES	Spigots were 240mm in from each end (20%)				
TEMPERATURE	20.6°C				
HUMIDITY	59%				
RESULTS					
Type	Structural Performance	Deflection	Residual	Time U/L	
I-III	Concentrated Load on Rail: 890N Uniform Linear Load on Rail: 290N/m Infill Horizontal Load: 220N				
I-IV	Concentrated Load on Rail: 890N Uniform Linear Load on Rail: 730N/m Infill Horizontal Load: 220N				
I-V	Concentrated Load on Rail: 1330N Uniform Linear Load on Rail: 730N/m Infill Horizontal Load: 220N	66.63mm	2.86mm	60sec	
		40.57mm	1.22mm	60sec	
		8.9mm	0mm	60sec	
I-VI	Concentrated Load on Rail: 1620N Uniform Linear Load on Rail: 880N/m Infill Horizontal Load: 220N				
Notes:					
<p>The Uniform Linear Load was multiplied by 1.2 as we tested with a 1200mm wide panel of glass.          The total loading for this test was 730N x 1.2 = 876N</p>					

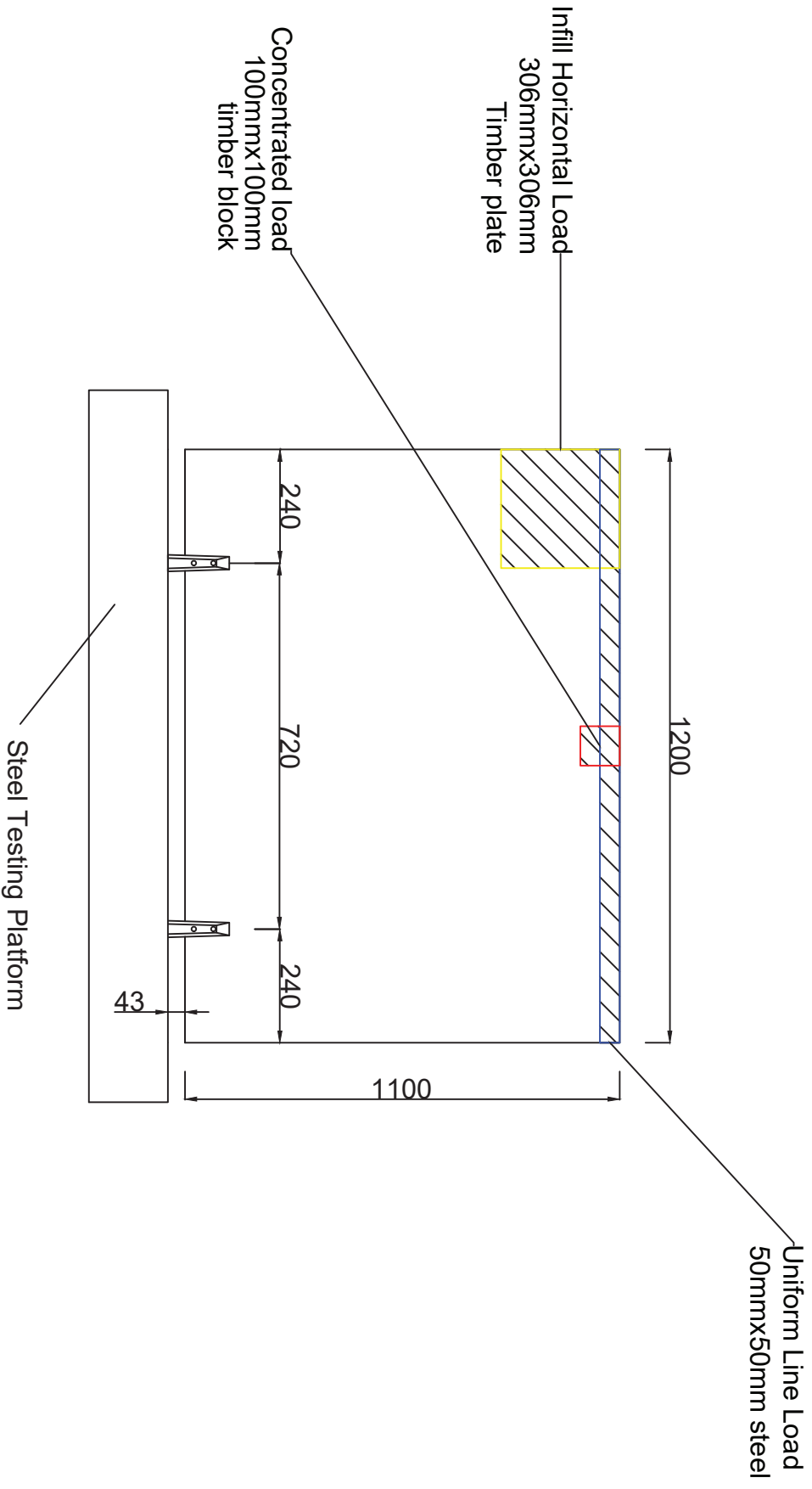

Part no: SE96X      Glass Type: 12mm Toughened Glass

Material: 2205 Duplex      Scale:

Fasteners used for testing: 316L SS M10 Bolts

2



1

BILL OF MATERIALS			
ITEM	PART NO.	DESCRIPTION	QTY.
1	SE96X	SPIGOT BODY	1
2	M12x20	GRUB SCREW	2
3	TLSF82-SN	MOUNTING NUT FOR M12 THREAD	1
4	TL7240SSPI	PRESSURE PLATE	1
5	TL7240PL	GASKET SHIM	1
6	TL7240PL	GASKET SHIM	1
7	TL7240SSPL	LEVELING PLATE	1

B

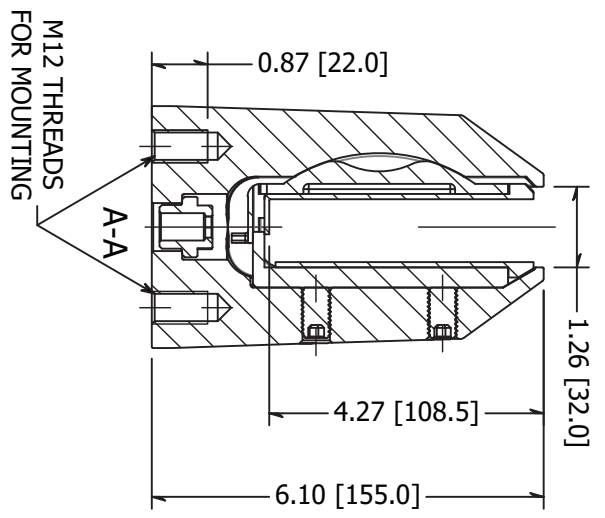
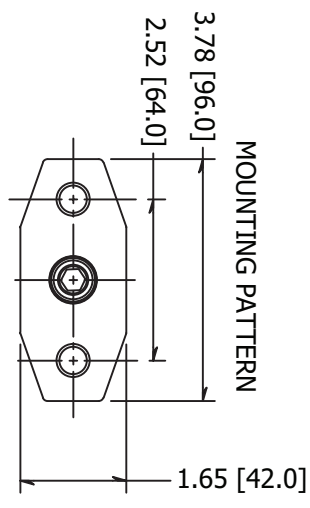
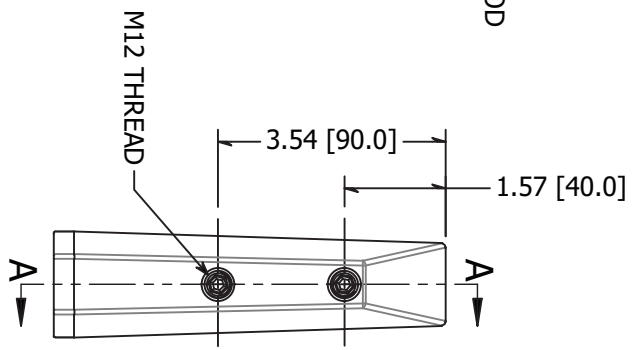
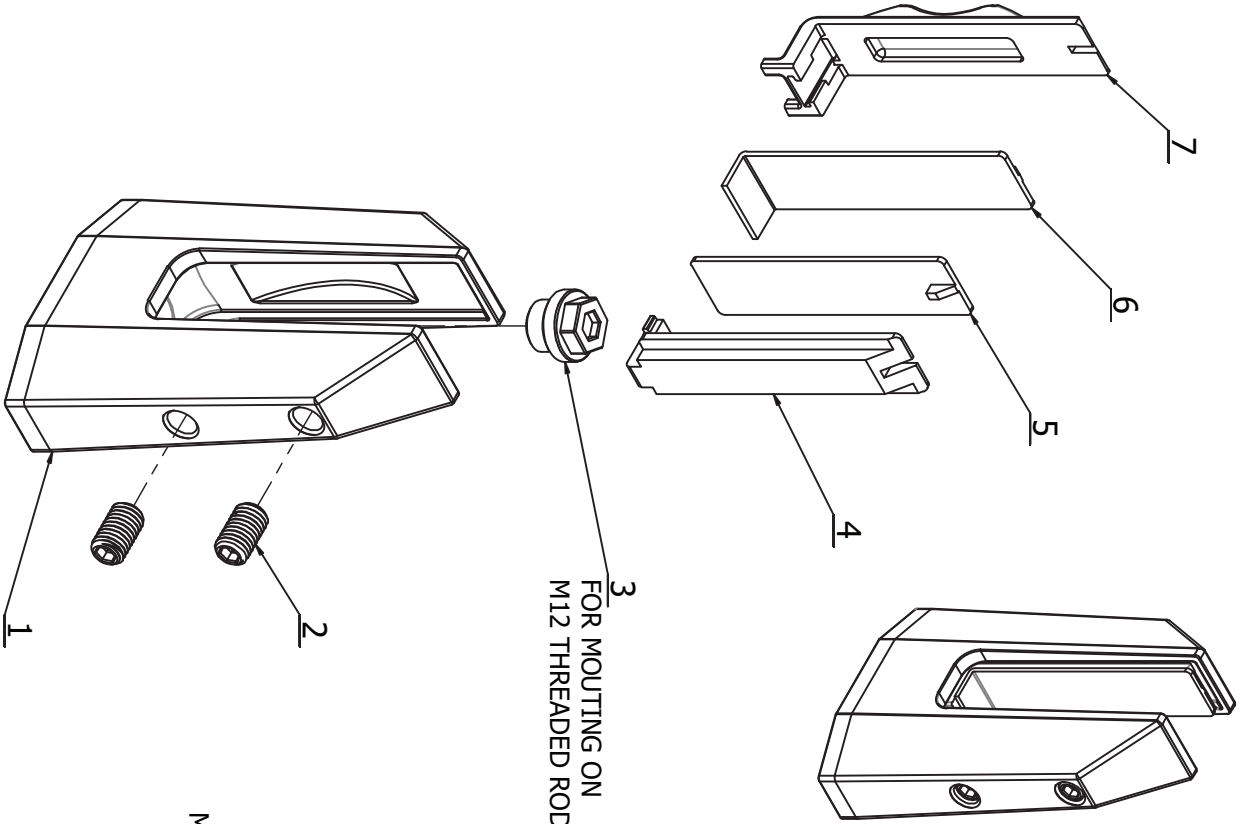

A

2



1

MATERIAL: 2205 SSTL	DESCRIPTION: Leveling Spigot, Center Concealed, For 12-25.52mm Glass, 6.1" High by 3.7" Wide
FINISH: #4	DATE: 2/13/2020
WEIGHT:	SCALE: REV:
ITEM NUMBER: GRSE96XS	ARCHITECTURAL SYSTEMS

**WAGNER** 10600 W Brown Deer Rd  
 ARCHITECTURAL SYSTEMS Milwaukee, WI 53224  
<http://www.wagnercompanies.com/>